

**Asbestos and Lead-based Paint Survey**

**Mastics - Moriches - Shirley Community Library  
Shirley, NY**

**ENVIROSCIENCE CONSULTANTS, INC.**

**2150 Smithtown Avenue**

**Ronkonkoma, NY 11779**

**(631) 580-3191**

**[WWW.ENVIROHEALTH.ORG](http://WWW.ENVIROHEALTH.ORG)**

**ASBESTOS and LEAD-BASED PAINT SURVEY**

**MASTICS - MORICHES - SHIRLEY COMMUNITY LIBRARY  
SHIRLEY, NY**

**JULY 2014**

Prepared for: MASTICS – MORICHES - SHIRLEY COMMUNITY LIBRARY  
407 William Floyd Parkway  
Shirley, New York 11967

Prepared by: ENVIROSCIENCE CONSULTANTS, INC.  
2150 Smithtown Avenue  
Ronkonkoma, New York 11779  
(631) 580-3191

Project Manager:

  
\_\_\_\_\_  
John V. Driscoll

TABLE OF CONTENTS

Survey of Asbestos Containing Materials

<u>Section</u>	<u>Title</u>
1.0	Executive Summary
2.0	Asbestos Survey
2.1	Asbestos Survey Procedures
2.2	Asbestos Sampling Procedures
2.3	Cost Estimates
3.0	Lead-based Paint Survey

Appendices

Appendix A	Asbestos Bulk Sample Results
Appendix B	Transmission Electron Microscopy (TEM) Air Results
Appendix C	Lead XRF Results
Appendix D	Sample Location Drawings
Appendix E	Inventory of Asbestos Containing Materials
Appendix F	Certifications

## 1.0 EXECUTIVE SUMMARY

The Mastics – Moriches - Shirley Community Library has retained Enviroscience Consultants, Inc., to conduct an asbestos and lead-based paint survey of the Library building located at 407 William Floyd Parkway, Shirley, NY. The purpose of this survey was to identify and quantify accessible asbestos containing materials (ACM), and lead painted surfaces and lead containing building components to facilitate renovations. Included in this report are Bulk Sample Results and an Inventory of Asbestos Containing Materials listing the quantity and location of identified ACM. An X-ray Fluorescence analyzer was used to test surfaces and components for lead. No Lead based paints were identified on any of the surfaces scheduled to be disturbed by the project, other than the sink in the employee bathroom. The lead-based paint survey is in Section 3.

The inspection was limited to system components and areas of the building that were accessible at the time of the inspection. The west roof over the original section of the building was not sampled in the first phase of the inspection. It was subsequently sampled and found to be non-asbestos containing. All accessible areas were inspected. Exploratory demolition into walls and pipe/duct chases was not performed. The following materials have been identified as ACM. Reference appendix E for specific locations:

Debris above 2' x 4' ceiling tiles and sheetrock ceiling in the Main Library Adult Section

There may be pipe and fitting insulation, and waterproofing materials located behind walls and ceilings that were not accessible at the time of inspection. Asbestos-containing materials may only be removed or disturbed by a certified and licensed asbestos abatement contractor. Air monitoring for asbestos abatement projects by an independent air-monitoring firm under contract of the Owner is required.



## 2.0 ASBESTOS SURVEY

### 2.1 Asbestos Survey Procedures

The asbestos survey was designed to meet all requirements specified in the *Asbestos Hazard Emergency Response Act (AHERA)*, and *NYS Asbestos Code Rule, 12 NYCRR Part 56, Subpart 56-5.1 Asbestos Survey Requirements for Building/Structure Demolition, Renovation, Remodeling and Repair*. A New York State certified asbestos inspector conducted the asbestos inspection. Enviroscience Consultants, Inc. a New York State Department of Health Environmental Laboratory Approval Program accredited laboratory, performed sample analysis.

New York State requires that the asbestos survey information be transmitted by the building owner as follows:

1. One copy of the completed asbestos survey shall be sent by the owner or their agent to the local government entity charged with issuing a permit for such demolition, renovation, remodeling or repair work under applicable State or local laws.
2. The completed asbestos survey for controlled demolition or pre-demolition asbestos projects shall also be submitted to the appropriate Asbestos Control Bureau district office.
3. The completed asbestos survey shall be kept on the construction site with the asbestos notification and variance, if required, throughout the duration of the asbestos project and any associated demolition, renovation, remodeling or repair project.

Enviroscience conducted a site investigation of the the building that included a visual inspection of all accessible areas subject to possible renovation. Material systems were assigned into groups of homogeneous materials. A homogeneous material is defined as a material that is alike in color and texture that was installed at the same time. Samples were then collected from each homogeneous area according to USEPA AHERA requirements. Based upon sample results, each sampled homogeneous area was classified as either asbestos or non-asbestos containing. An asbestos containing material is defined by the USEPA as a material containing greater than one percent asbestos by weight.

John V. Driscoll and Edik Ivans, NYS certified Asbestos Inspectors, conducted the inspection. Certifications are provided in appendix F. Asbestos-containing materials are noted above in the Executive Summary. Also reference the Asbestos Bulk Sample Results in appendix A.

The only ACM identified in the building was the debris above the ceiling tiles in the main section of the library. The debris is a black tar-like granular material, and is most likely roof debris from the original roof. After discovering the asbestos containing debris, Enviroscience returned to the library to collect additional samples from above the ceiling. Asbestos containing debris was identified in three of seven locations. However, the locations are on both areas of the suspended ceiling tiles in the Adult Section. This condition requires that the ceiling tiles must be considered contaminated throughout the Adult Section of the Library. The sheetrock ceiling in the adult section is assumed to have the debris present on the upper side of the ceiling. These tiles and the sheetrock ceiling should not be disturbed.

Enviroscience collected air samples throughout the library and in three areas above the ceiling tiles in the West Section of the building. The samples were analyzed using Transmission Electron Microscopy (TEM) methods. No asbestos structures were detected in any of the samples. The fact that the debris is a non-friable organically bound material makes airborne fiber release unlikely.

Any asbestos containing materials that will be disturbed during renovation or demolition must be removed by a NYS certified and licensed asbestos abatement contractor. Air monitoring is required for asbestos projects.

The following materials have been classified as non-asbestos containing and may be removed or disturbed as regular construction materials:

- Roof Flashing & Vapor Barrier on New (East) Addition and West Side
- Carpet Mastics
- Joint Compounds
- Sheetrock
- Ceramic Tile Grout
- Base Cove Mastic
- 12" x 12" Floor Tiles and Mastic
- Concrete
- 2' x 4' Ceiling Tiles and 2' x 2' Ceiling Tiles
- Stair Tread
- Debris in New Wing

Refer to the Bulk Sample Results in Appendix A for detailed sample information and ACM locations.



## 2.2 Asbestos Sampling Procedures

Samples of suspect asbestos materials were collected in accordance with United States Environmental Protection Agency guidelines as outlined below. These sampling procedures were implemented in an effort to minimize the release of asbestos fibers during sampling and to provide control of samples through analysis and reporting.

Samples were collected in unoccupied areas.

A half-face respirator may be worn during bulk sample collection.

Surfaces of the material to be sampled were wetted with water mist prior to collection.

Samples were collected with a cork borer, knife, or other approved sampling tool.

Sampling tools were decontaminated between each sample.

Individual sealable containers were used to contain each of the collected samples. Samples were double-bagged for transportation to the laboratory.

Sample containers were labeled with a date and unique sample ID number using a permanent marker.

At the completion of sampling activities, bulk samples were transported and relinquished to the laboratory for analysis. Enviroscience Consultants, Inc. is a New York State Department of Health (NYSDOH) Environmental Laboratory Approval Program (ELAP #11681) accredited environmental testing laboratory.

All asbestos bulk samples were analyzed by Polarized Light Microscopy (PLM). Samples of non-friable organically bound (NOB) materials such as floor tiles and roofing materials or ceiling tiles found to contain cellulose that were found to contain less than 1% asbestos by PLM were then analyzed using Transmission Electron Microscopy (TEM). According to the Department of Health, NOB materials and ceiling tiles containing cellulose must first be analyzed by PLM. If asbestos is not found using polarized light microscopy, the sample must be analyzed with the higher-powered transmission electron microscope.

## 2.3 Cost Estimates

Based upon approximately 12,000 square feet of contaminated ceiling tiles and sheetrock, Enviroscience estimates the cost for the removal of the ceiling tiles and grid and sheetrock and cleaning of the space above the ceiling to be \$250,000.00, including air monitoring fees.

### 3.0 LEAD-BASED PAINT SURVEY

Enviroscience Consultants Inc. conducted a Lead-based Paint Inspection of surfaces and components that may be disturbed by the renovations. An EPA certified lead inspector used an X-ray Fluorescence (XRF) analyzer to inspect the buildings in accordance with the New York State Education Department requirements and the US Housing and Urban Development Agency Guidelines for the Evaluation and Control of Lead-based Paint in Housing, Chapter 7, Lead-based Paint Inspection, 1997 Revision.

**All components tested for lead-based paint were below 1.0 mg/cm<sup>2</sup>, except for the sink in the employee bathroom.**

All workers involved in construction and demolition activities are covered under The OSHA Lead Exposure in Construction Rule (29 CFR 1926.62). This standard requires workers to be trained and protected from lead exposure by use of engineering controls, respiratory protection, protective clothing and medical surveillance when airborne concentration of lead exceed established PEL levels.

Reference the Lead Paint Inspection Report sheets in appendix C.



**Appendix A - Bulk Sample Results**

# ENVIROSCIENCE CONSULTANTS, INC.

2150 SMITHTOWN AVE. + RONKONKOMA, NY 11779 + (631) 580-3191  
344 MAIN ST., SUITE 101 + MT. KISCO, NY 10549 + (914) 666-8933

ELAP # 11681; NVLAP Lab Code 200531-0

## ASBESTOS BULK SAMPLE RESULTS

CLIENT: Mastics-Moriches-Shirley Community Library SAMPLE DATE: 7/9/2014  
PROJECT NAME: Mastic Moriches Shirley Community Library DATE RECEIVED: 7/9/2014  
JOB #: 11350 AREA: Interior & Exterior  
PAGE #: 1 of 9 SAMPLER: John Driscoll  
CUSTODY #: 11203

Sample #	Description	Color	Location	Result	% Asbestos-type	% Non-asbestos Fibers-type	% Matrix-type
1	Roof Flashing	Black	South Roof	None Detected by TEM	None Detected	None Detected	97.6% organics and carbonates 2.4% silicates and opaques
2	Roof Flashing	Black	South Roof	None Detected by TEM	None Detected	None Detected	96.6% organics and carbonates 3.4% silicates and opaques
3	Vapor Barrier	Black	South Roof Under EPDM	None Detected by TEM	None Detected	None Detected	89.9% organics and carbonates 10.1% silicates and opaques
4	Vapor Barrier	Black	South Roof Under EPDM	None Detected by TEM	None Detected	None Detected	88.2% organics and carbonates 11.8% silicates and opaques
5	Carpet Mastic	Gold	New Edition Upper Floor	None Detected by TEM	None Detected	None Detected	55.1% organics and carbonates 44.9% silicates and opaques
6	Carpet Mastic	Gold	New Addition Basement	None Detected by TEM	None Detected	None Detected	52.7% organics and carbonates 47.3% silicates and opaques

**Key:**  
ACM: Asbestos Containing Materials contain more than 1% asbestos (shown in bold type). This method (ELAP 198.6) does not remove vermiculite and may underestimate the level of asbestos present in a sample containing greater than 10% vermiculite.  
Trace - Asbestos found is 1% or less; not considered ACM.  
None Detected - No asbestos found in samples using polarized light microscopy (PLM).  
None Detected by TEM - No asbestos found in samples using transmission electron microscopy (TEM) and polarized light microscopy (PLM) was found to be negative.  
Negative by Weight - After matrix reduction, the remainder is less than 1% and, therefore, cannot fulfill the definition of asbestos containing material.  
Inconclusive - No asbestos found in non-friable organically bound samples using polarized light microscopy (PLM).  
Method: EPA 600/M4-82/20, ELAP Item 198.6 This report may not be reproduced without the express permission of Enviroscience. This report cannot be used to claim endorsement of products by NVLAP or any agency of the U.S. Government. Test results only reflect conditions at the time the samples were taken.

*John Driscoll*

Analyzed by: \_\_\_\_\_ Date Analyzed: 7/14/2014

# ENVIROSCIENCE CONSULTANTS, INC.

2150 SMITHTOWN AVE. + RONKONKOMA, NY 11779 + (631) 580-3191  
 344 MAIN ST., SUITE 101 + MT. KISCO, NY 10549 + (914) 666-8933

ELAP # 11681; NVLAP Lab Code 200531-0

## ASBESTOS BULK SAMPLE RESULTS

CLIENT: Mastics-Moriches-Shirley Community Library      SAMPLE DATE: 7/9/2014  
 PROJECT NAME: Mastic Moriches Shirley Community Library      DATE RECEIVED: 7/9/2014  
 AREA: Interior & Exterior  
 JOB #: 11350      SAMPLER: John Driscoll  
 PAGE #: 2 of 9      CUSTODY #: 11203

Sample #	Description	Color	Location	Result	% Asbestos-type Fibers-type	% Non-asbestos Fibers-type	% Matrix-type
7	Joint Compound	White	New Wing Basement	None Detected		5.0% cellulose	95.0% plaster
8	Joint Compound	White	New Wing Basement	None Detected		5.0% cellulose	95.0% plaster
9	Base Cove Mastic	Tan	New Wing Basement	None Detected by TEM		None Detected	65.2% organics and carbonates 34.8% silicates and opaques
10	Base Cove Mastic	Tan	New Wing Basement	None Detected by TEM		None Detected	65.9% organics and carbonates 34.1% silicates and opaques
11	Sheetrock	White	New Wing Basement	None Detected		15.0% cellulose 5.0% fiberglass	80.0% plaster
12	Sheetrock	White	New Wing Main Floor	None Detected		15.0% cellulose 5.0% fiberglass	80.0% plaster
13	2x2 Recessed Ceiling Tile	Tan	New Wing Main Floor	None Detected by TEM		None Detected	38.4% organics and carbonates 61.6% silicates and opaques

**Key:**  
 ACM: Asbestos Containing Materials contain more than 1% asbestos (shown in bold type).  
 This method (ELAP 198.6) does not remove vermiculite and may underestimate the level of asbestos present in a sample containing greater than 10% vermiculite.  
 Trace - Asbestos found is 1% or less; not considered ACM.  
 None Detected - No asbestos found in samples using polarized light microscopy (PLM).  
 None Detected by TEM - No asbestos found in samples using transmission electron microscopy (TEM) and polarized light microscopy (PLM) was found to be negative.  
 Negative by Weight - After matrix reduction, the remainder is less than 1% and, therefore, cannot fulfill the definition of asbestos containing material.  
 Inconclusive - No asbestos found in non-friable organically bound samples using polarized light microscopy (PLM).  
 Method: EPA 600/M4-82/20, ELAP Item 198.6 This report may not be reproduced without the express permission of Enviroscience. This report cannot be used to claim endorsement of products by NVLAP or any agency of the U.S. Government. Test results only reflect conditions at the time the samples were taken.

*John Driscoll*

Analyzed by: \_\_\_\_\_ Date Analyzed: 7/14/2014



# ENVIROSCIENCE CONSULTANTS, INC.

2150 SMITHTOWN AVE. + RONKONKOMA, NY 11779 + (631) 580-3191  
 344 MAIN ST., SUITE 101 + MT. KISCO, NY 10549 + (914) 666-8933

ELAP # 11681; NVLAP Lab Code 200531-0

## ASBESTOS BULK SAMPLE RESULTS

CLIENT: Mastics-Moriches-Shirley Community Library      SAMPLE DATE: 7/9/2014  
 PROJECT NAME: Mastic Moriches Shirley Community Library      DATE RECEIVED: 7/9/2014  
 AREA: Interior & Exterior  
 JOB #: 11350      SAMPLER: John Driscoll  
 PAGE #: 3 of 9      CUSTODY #: 11203

Sample #	Description	Color	Location	Result	% Asbestos-type	% Non-asbestos Fibers-type	% Matrix-type
14	2x2 Recessed Ceiling Tile	Tan	New Wing Basement	None Detected by TEM	None Detected	None Detected	43.1% organics and carbonates 56.9% silicates and opaques
15	12x12 Floor Tile	Grey w/ Blue	Basement	None Detected by TEM	None Detected	None Detected	99.0% organics and carbonates 1.0% silicates and opaques
16	Floor Tile Mastic	Black	Basement	None Detected by TEM	None Detected	None Detected	95.0% organics and carbonates 5.0% silicates and opaques
17	12x12 Floor Tile	Grey w/ Blue	Basement	None Detected by TEM	None Detected	None Detected	99.4% organics and carbonates 0.6% silicates and opaques
18	Floor Tile Mastic	Black	Basement	None Detected by TEM	None Detected	None Detected	96.7% organics and carbonates 3.3% silicates and opaques
19	Concrete	Grey	New Wing Substation	None Detected	None Detected	3.0% cellulose	97.0% cement

**Key:**  
 ACM: Asbestos Containing Materials contain more than 1% asbestos (shown in bold type).  
 This method (ELAP 198.6) does not remove vermiculite and may underestimate the level of asbestos present in a sample containing greater than 10% vermiculite.  
 Trace - Asbestos found is 1% or less; not considered ACM.  
 None Detected - No asbestos found in samples using polarized light microscopy (PLM).  
 None Detected by TEM - No asbestos found in samples using transmission electron microscopy (TEM) and polarized light microscopy (PLM) was found to be negative.  
 Negative by Weight - After matrix reduction, the remainder is less than 1% and, therefore, cannot fulfill the definition of asbestos containing material.  
 Inconclusive - No asbestos found in non-friable organically bound samples using polarized light microscopy (PLM).  
 Method: EPA 600/M4-82/20, ELAP Item 198.6 This report may not be reproduced without the express permission of Enviroscience. This report cannot be used to claim endorsement of products by NVLAP or any agency of the U.S. Government. Test results only reflect conditions at the time the samples were taken.

*John Driscoll*

Analyzed by: \_\_\_\_\_ Date Analyzed: 7/14/2014

# ENVIROSCIENCE CONSULTANTS, INC.

2150 SMITHTOWN AVE. + RONKONKOMA, NY 11779 + (631) 580-3191  
 344 MAIN ST., SUITE 101 + MT. KISCO, NY 10549 + (914) 666-8933

ELAP # 11681; NVLAP Lab Code 200531-0

## ASBESTOS BULK SAMPLE RESULTS

CLIENT:	Mastics-Moriches-Shirley Community Library	SAMPLE DATE:	7/9/2014
PROJECT NAME:	Mastic Moriches Shirley Community Library	DATE RECEIVED:	7/9/2014
JOB #:	11350	AREA:	Interior & Exterior
PAGE #:	4 of 9	SAMPLER:	John Driscoll
		CUSTODY #:	11203

Sample #	Description	Color	Location	Result	% Asbestos-type	% Non-asbestos Fibers-type	% Matrix-type
20	Concrete	Grey	New Wing Substation	None Detected		3.0% cellulose	97.0% cement
21	Concrete	Grey	New Wing Substation	None Detected		3.0% cellulose	97.0% cement
22	2x4 Recessed Ceiling Tile	Grey	New Wing Subcellar	None Detected by TEM		None Detected	40.3% organics and carbonates 59.7% silicates and opaques
23	2x4 Recessed Ceiling Tile	Grey	New Wing Subcellar	None Detected by TEM		None Detected	44.2% organics and carbonates 55.8% silicates and opaques
24	12x12 Floor Tile	Grey	New Wing Subcellar	None Detected by TEM		None Detected	96.6% organics and carbonates 3.4% silicates and opaques
25	Floor Tile Mastic	Tan	New Wing Subcellar	None Detected by TEM		None Detected	96.6% organics and carbonates 3.4% silicates and opaques

**Key:**  
 ACM: Asbestos Containing Materials contain more than 1% asbestos (shown in bold type).  
 This method (ELAP 198.6) does not remove vermiculite and may underestimate the level of asbestos present in a sample containing greater than 10% vermiculite.  
 Trace - Asbestos found is 1% or less; not considered ACM.  
 None Detected - No asbestos found in samples using polarized light microscopy (PLM).  
 None Detected by TEM - No asbestos found in samples using transmission electron microscopy (TEM) and polarized light microscopy (PLM) was found to be negative.  
 Negative by Weight - After matrix reduction, the remainder is less than 1% and, therefore, cannot fulfill the definition of asbestos containing material.  
 Inconclusive - No asbestos found in non-friable organically bound samples using polarized light microscopy (PLM).  
 Method: EPA 600/M4-82/20, ELAP Item 198.6 This report may not be reproduced without the express permission of Enviroscience. This report cannot be used to claim endorsement of products by NVLAP or any agency of the U.S. Government. Test results only reflect conditions at the time the samples were taken.

*John Driscoll*

Analyzed by: \_\_\_\_\_ Date Analyzed: 7/14/2014



# ENVIROSCIENCE CONSULTANTS, INC.

2150 SMITHTOWN AVE. + RONKONKOMA, NY 11779 + (631) 580-3191  
 344 MAIN ST., SUITE 101 + MT. KISCO, NY 10549 + (914) 666-8933

ELAP # 11681; NVLAP Lab Code 200531-0

## ASBESTOS BULK SAMPLE RESULTS

CLIENT: Mastics-Moriches-Shirley Community Library      SAMPLE DATE: 7/9/2014  
 PROJECT NAME: Mastic Moriches Shirley Community Library      DATE RECEIVED: 7/9/2014  
 AREA: Interior & Exterior  
 JOB #: 11350      SAMPLER: John Driscoll  
 PAGE #: 5 of 9      CUSTODY #: 11203

Sample #	Description	Color	Location	Result	% Asbestos-type Fibers-type	% Non-asbestos Fibers-type	% Matrix-type
26	12x12 Floor Tile	Grey	New Wing Subcellar	None Detected by TEM	None Detected	None Detected	96.1% organics and carbonates 3.9% silicates and opaques
27	Floor Tile Mastic	Tan	New Wing Subcellar	None Detected by TEM	None Detected	None Detected	87.5% organics and carbonates 12.5% silicates and opaques
28	12x12 Floor Tile	Tan	Basement	None Detected by TEM	2.2% talc	2.2% talc	78.3% organics and carbonates 19.5% silicates and opaques
29	Floor Tile Mastic	Black	Basement	None Detected by TEM	1.6% talc	1.6% talc	84.3% organics and carbonates 14.1% silicates and opaques
30	12x12 Floor Tile	Tan	Basement	None Detected by TEM	2.0% talc	2.0% talc	79.9% organics and carbonates 18.1% silicates and opaques
31	Floor Tile Mastic	Black	Basement	None Detected by TEM	1.1% talc	1.1% talc	89.1% organics and carbonates 9.8% silicates and opaques

**Key:**  
 ACM: Asbestos Containing Materials contain more than 1% asbestos (shown in bold type).  
 This method (ELAP 198.6) does not remove vermiculite and may underestimate the level of asbestos present in a sample containing greater than 10% vermiculite.  
 Trace - Asbestos found is 1% or less; not considered ACM.  
 None Detected - No asbestos found in samples using polarized light microscopy (PLM).  
 None Detected by TEM - No asbestos found in samples using transmission electron microscopy (TEM) and polarized light microscopy (PLM) was found to be negative.  
 Negative by Weight - After matrix reduction, the remainder is less than 1% and, therefore, cannot fulfill the definition of asbestos containing material.  
 Inconclusive - No asbestos found in non-friable organically bound samples using polarized light microscopy (PLM).  
 Method: EPA 600/M4-82/20, ELAP Item 198.6 This report may not be reproduced without the express permission of Enviroscience. This report cannot be used to claim endorsement of products by NVLAP or any agency of the U.S. Government. Test results only reflect conditions at the time the samples were taken.

*John Driscoll*

Analyzed by: \_\_\_\_\_ Date Analyzed: 7/14/2014



# ENVIROSCIENCE CONSULTANTS, INC.

2150 SMITHTOWN AVE. + RONKONKOMA, NY 11779 + (631) 580-3191  
 344 MAIN ST., SUITE 101 + MT. KISCO, NY 10549 + (914) 666-8933

ELAP # 11681; NVLAP Lab Code 200531-0

## ASBESTOS BULK SAMPLE RESULTS

CLIENT:	Mastics-Moriches-Shirley Community Library	SAMPLE DATE:	7/9/2014
PROJECT NAME:	Mastic Moriches Shirley Community Library	DATE RECEIVED:	7/9/2014
JOB #:	11350	AREA:	Interior & Exterior
PAGE #:	6 of 9	SAMPLER:	John Driscoll
		CUSTODY #:	11203

Sample #	Description	Color	Location	Result	% Asbestos-type	% Non-asbestos Fibers-type	% Matrix-type
32	Sheetrock	Grey	Basement	None Detected		20.0% cellulose	80.0% plaster
33	Carpet Mastic	Gold	Basement	None Detected by TEM		None Detected	61.0% organics and carbonates 39.0% silicates and opaques
34	Base Cove Mastic	Tan	Basement	None Detected by TEM		None Detected	44.0% organics and carbonates 56.0% silicates and opaques
35	Carpet Mastic	Tan	Main Floor	None Detected by TEM		None Detected	63.2% organics and carbonates 36.8% silicates and opaques
36	Sheetrock	Tan	Main Floor	None Detected		20.0% cellulose	80.0% plaster
37	Base Cove Mastic	Tan	Main Floor	None Detected by TEM		None Detected	43.8% organics and carbonates 56.2% silicates and opaques

**Key:**  
 ACM: Asbestos Containing Materials contain more than 1% asbestos (shown in bold type).  
 This method (ELAP 198.6) does not remove vermiculite and may underestimate the level of asbestos present in a sample containing greater than 10% vermiculite.  
 Trace - Asbestos found is 1% or less; not considered ACM.  
 None Detected - No asbestos found in samples using polarized light microscopy (PLM).  
 None Detected by TEM - No asbestos found in samples using transmission electron microscopy (TEM) and polarized light microscopy (PLM) was found to be negative.  
 Negative by Weight - After matrix reduction, the remainder is less than 1% and, therefore, cannot fulfill the definition of asbestos containing material.  
 Inconclusive - No asbestos found in non-friable organically bound samples using polarized light microscopy (PLM).  
 Method: EPA 600/M4-82/20, ELAP Item 198.6 This report may not be reproduced without the express permission of Enviroscience. This report cannot be used to claim endorsement of products by NVLAP or any agency of the U.S. Government. Test results only reflect conditions at the time the samples were taken.

*John Driscoll*

Analyzed by: \_\_\_\_\_ Date Analyzed: 7/14/2014

# ENVIROSCIENCE CONSULTANTS, INC.

2150 SMITHTOWN AVE. + RONKONKOMA, NY 11779 + (631) 580-3191  
 344 MAIN ST., SUITE 101 + MT. KISCO, NY 10549 + (914) 666-8933

ELAP # 11681; NVLAP Lab Code 200531-0

## ASBESTOS BULK SAMPLE RESULTS

CLIENT: Mastics-Moriches-Shirley Community Library      SAMPLE DATE: 7/9/2014  
 PROJECT NAME: Mastic Moriches Shirley Community Library      DATE RECEIVED: 7/9/2014  
 AREA: Interior & Exterior  
 JOB #: 11350      SAMPLER: John Driscoll  
 PAGE #: 7 of 9      CUSTODY #: 11203

Sample #	Description	Color	Location	Result	% Asbestos-type	% Non-asbestos Fibers-type	Matrix-type
38	Joint Compound	White	Main Floor	None Detected		5.0% cellulose	95.0% plaster
39	Joint Compound	White	Main Floor	None Detected		5.0% cellulose	95.0% plaster
40	Ceramic Tile Grout	White	Front Lobby Bathrooms	None Detected		3.0% cellulose	97.0% silicates and carbonates
41	Ceramic Tile Grout	White	Front Lobby Bathrooms	None Detected		3.0% cellulose	97.0% silicates and carbonates
42	Stair Tread	Brown	South Starwell	None Detected by TEM		None Detected	47.2% organics and carbonates
43	Stair Tread	Brown	South Starwell	None Detected by TEM		None Detected	52.8% silicates and opaques
44	2x2 Speckled Ceiling Tile	Grey	South Office Area	None Detected by TEM		31.8% mineral wool	46.5% organics and carbonates
							36.4% organics and carbonates
							31.8% silicates and opaques

**Key:**  
**ACM:** Asbestos Containing Materials contain more than 1% asbestos (shown in bold type). This method (ELAP 198.6) does not remove vermiculite and may underestimate the level of asbestos present in a sample containing greater than 10% vermiculite.  
**Trace -** Asbestos found is 1% or less; not considered ACM.  
**None Detected -** No asbestos found in samples using polarized light microscopy (PLM).  
**None Detected by TEM -** No asbestos found in samples using transmission electron microscopy (TEM) and polarized light microscopy (PLM) was found to be negative.  
**Negative by Weight -** After matrix reduction, the remainder is less than 1% and, therefore, cannot fulfill the definition of asbestos containing material.  
**Inconclusive -** No asbestos found in non-friable organically bound samples using polarized light microscopy (PLM).  
**Method:** EPA 600/M4-82/20, ELAP Item 198.6 This report may not be reproduced without the express permission of Enviroscience. This report cannot be used to claim endorsement of products by NVLAP or any agency of the U.S. Government. Test results only reflect conditions at the time the samples were taken.

*John Driscoll*

Analyzed by: \_\_\_\_\_ Date Analyzed: 7/14/2014



# ENVIROSCIENCE CONSULTANTS, INC.

2150 SMITHTOWN AVE. + RONKONKOMA, NY 11779 + (631) 580-3191  
 344 MAIN ST., SUITE 101 + MT. KISCO, NY 10549 + (914) 666-8933

ELAP # 11681; NVLAP Lab Code 200531-0

## ASBESTOS BULK SAMPLE RESULTS

CLIENT:	Mastics-Moriches-Shirley Community Library	SAMPLE DATE:	7/9/2014
PROJECT NAME:	Mastic Moriches Shirley Community Library	DATE RECEIVED:	7/9/2014
JOB #:	11350	AREA:	Interior & Exterior
PAGE #:	8 of 9	SAMPLER:	John Driscoll
		CUSTODY #:	11203

Sample #	Description	Color	Location	Result	% Asbestos-type	% Non-asbestos Fibers-type	% Matrix-type
45	2x2 Speckled Ceiling Tile	Grey	South Office Area	None Detected by TEM		33.6% mineral wool	32.8% organics and carbonates 33.6% silicates and opaques
46	2x4 CT Textured Pinhole	Grey	Main Library	None Detected by TEM		35.6% mineral wool	28.9% organics and carbonates 35.5% silicates and opaques
47	2x4 CT Textured Pinhole	Grey	Main Library	None Detected by TEM		29.7% mineral wool	40.7% organics and carbonates 29.6% silicates and opaques
48	2x4 CT Speckled	Grey	Copy Room	None Detected by TEM		30.9% mineral wool	38.2% organics and carbonates 30.9% silicates and opaques
49	2x4 CT Speckled	Grey	Main Library	None Detected by TEM		30.4% mineral wool	39.1% organics and carbonates 30.5% silicates and opaques
50	2x4 CT Fissured	Grey	By Private Study Room	None Detected by TEM		31.3% mineral wool	37.4% organics and carbonates 31.3% silicates and opaques

**Key:**  
 ACM: Asbestos Containing Materials contain more than 1% asbestos (shown in bold type).  
 This method (ELAP 198.6) does not remove vermiculite and may underestimate the level of asbestos present in a sample containing greater than 10% vermiculite.  
 Trace - Asbestos found is 1% or less; not considered ACM.  
 None Detected - No asbestos found in samples using polarized light microscopy (PLM).  
 None Detected by TEM - No asbestos found in samples using transmission electron microscopy (TEM) and polarized light microscopy (PLM) was found to be negative.  
 Negative by Weight - After matrix reduction, the remainder is less than 1% and, therefore, cannot fulfill the definition of asbestos containing material.  
 Inconclusive - No asbestos found in non-friable organically bound samples using polarized light microscopy (PLM).  
 Method: EPA 600/M4-82/20, ELAP Item 198.6 This report may not be reproduced without the express permission of Enviroscience. This report cannot be used to claim endorsement of products by NVLAP or any agency of the U.S. Government. Test results only reflect conditions at the time the samples were taken.

*John Driscoll*

Analyzed by: \_\_\_\_\_ Date Analyzed: 7/14/2014



# ENVIROSCIENCE CONSULTANTS, INC.

2150 SMITHTOWN AVE. + RONKONKOMA, NY 11779 + (631) 580-3191  
 344 MAIN ST., SUITE 101 + MT. KISCO, NY 10549 + (914) 666-8933

ELAP # 11681; NVLAP Lab Code 200531-0

## ASBESTOS BULK SAMPLE RESULTS

CLIENT: Mastics-Moriches-Shirley Community Library      SAMPLE DATE: 7/9/2014  
 PROJECT NAME: Mastic Moriches Shirley Community Library      DATE RECEIVED: 7/9/2014  
 AREA: Interior & Exterior  
 JOB #: 11350      SAMPLER: John Driscoll  
 PAGE #: 9 of 9      CUSTODY #: 11203

Sample #	Description	Color	Location	Result	% Asbestos-type	% Non-asbestos Fibers-type	% Matrix-type
51	2x4 CT Fissured	Grey	By Private Study Room	None Detected by TEM		33.0% mineral wool	34.0% organics and carbonates 33.0% silicates and opaques
52	Debris Above CT	Grey	Quiet Study Lower Level	None Detected		3.0% cellulose	97.0% binders
53	Debris Above CT	Black	Main Level Adult Section	22.2% Asbestos	22.2% Chrysotile	None Detected	66.8% organics and carbonates 11.0% silicates and opaques

**Key:**  
 ACM: Asbestos Containing Materials contain more than 1% asbestos (shown in bold type).  
 This method (ELAP 198.6) does not remove vermiculite and may underestimate the level of asbestos present in a sample containing greater than 10% vermiculite.  
 Trace - Asbestos found is 1% or less; not considered ACM.  
 None Detected - No asbestos found in samples using polarized light microscopy (PLM).  
 None Detected by TEM - No asbestos found in samples using transmission electron microscopy (TEM) and polarized light microscopy (PLM) was found to be negative.  
 Negative by Weight - After matrix reduction, the remainder is less than 1% and, therefore, cannot fulfill the definition of asbestos containing material.  
 Inconclusive - No asbestos found in non-friable organically bound samples using polarized light microscopy (PLM).  
 Method: EPA 600/M4-82/20, ELAP Item 198.6 This report may not be reproduced without the express permission of Enviroscience. This report cannot be used to claim endorsement of products by NVLAP or any agency of the U.S. Government. Test results only reflect conditions at the time the samples were taken.

*John Driscoll*

Analyzed by: \_\_\_\_\_ Date Analyzed: 7/14/2014

# ENVIROSCIENCE CONSULTANTS, INC.

2150 SMITHTOWN AVE. + RONKONKOMA, NY 11779 + (831) 580-3191  
 344 MAIN ST., SUITE 101 + MT. KISCO, NY 10549 + (914) 666-8933

ELAP # 11681; NVLAP Lab Code 200531-0

## ASBESTOS BULK SAMPLE RESULTS

CLIENT: Mastics-Moriches-Shirley Community Library      SAMPLE DATE: 7/24/2014  
 PROJECT NAME: Mastic Moriches Shirley Community Library      DATE RECEIVED: 7/24/2014  
 AREA: Interior-Above Ceiling  
 JOB #: 11350      SAMPLER: Edik Ivans  
 PAGE #: 1 of 3      CUSTODY #: 11471

Sample #	Description	Color	Location	Result	% Asbestos-type by TEM	% Non-asbestos Fibers-type	% Matrix-type
P1	Debris	Gray/Black	Area # 1	None Detected		70.0% cellulose	30.0% binders
P2	Debris	Gray/Black	Area # 1	None Detected		98.0% cellulose	2.0% binders
P3	Debris	Gray/Black	Area # 2	1.4% Asbestos by TEM	1.4% Chrysotile by TEM	1.4% fibreglass	93.0% organics and carbonates 4.2% silicates and opaques
P4	Debris	Gray/Black	Area # 2	3.1% Asbestos by TEM	3.1% Chrysotile by TEM	1.5% fibreglass	69.1% organics and carbonates 26.3% silicates and opaques
P5	Debris	Gray/Black	Area # 3	None Detected by TEM		None Detected	8.2% organics and carbonates 91.8% silicates and opaques
P6	Debris	Gray/Black	Area # 3	None Detected by TEM		None Detected	94.4% organics and carbonates 5.6% silicates and opaques

**Key:**  
 ACM: Asbestos Containing Materials contain more than 1% asbestos (shown in bold type).  
 This method (ELAP 198.6) does not remove vermiculite and may underestimate the level of asbestos present in a sample containing greater than 10% vermiculite.  
 Trace - Asbestos found is 1% or less; not considered ACM.  
 None Detected - No asbestos found in samples using polarized light microscopy (PLM).  
 None Detected by TEM - No asbestos found in samples using transmission electron microscopy (TEM) and polarized light microscopy (PLM) was found to be negative.  
 Negative by Weight - After matrix reduction, the remainder is less than 1% and, therefore, cannot fulfill the definition of asbestos containing material.  
 Inconclusive - No asbestos found in non friable organically bound samples using polarized light microscopy (PLM).  
 Method: EPA 600/M4-82/20, ELAP Item 198.6 This report may not be reproduced without the express permission of Enviroscience. This report cannot be used to claim endorsement of products by NVLAP or any agency of the U.S. Government. Test results only reflect conditions at the time the samples were taken.

*Edward J. Schuchman*

Analyzed by: \_\_\_\_\_ Date Analyzed: 7/30/2014



# ENVIROSCIENCE CONSULTANTS, INC.

2150 SMITHTOWN AVE. \* RONKONKOMA, NY 11779 \* (631) 580-3191  
 344 MAIN ST., SUITE 101 \* MT. KISCO, NY 10549 \* (914) 666-8933

ELAP # 11681; NVLAP Lab Code 200531-0

## ASBESTOS BULK SAMPLE RESULTS

CLIENT:	Mastics-Moriches-Shirley Community Library	SAMPLE DATE:	7/24/2014
PROJECT NAME:	Mastic Moriches Shirley Community Library	DATE RECEIVED:	7/24/2014
JOB #:	11350	AREA:	Interior-Above Ceiling
PAGE #:	2 of 3	SAMPLER:	Edik Ivans
		CUSTODY #:	11471

Sample #	Description	Color	Location	Result	% Asbestos-type	% Non-asbestos Fibers-type	% Matrix-type
P7	Debris	Gray/Black	Area # 4	None Detected by TEM		None Detected	90.3% organics and carbonates 9.7% silicates and opaques
P8	Debris	Gray/Black	Area # 4	None Detected by TEM		6.5% fiberglass	57.0% organics and carbonates 36.5% silicates and opaques
<b>P9</b>	<b>Debris</b>	<b>Gray/Black</b>	<b>Area # 5</b>	<b>2.1% Asbestos</b>	<b>2.1% Chrysotile</b>	<b>0.6% fiberglass</b>	<b>93.8% organics and carbonates</b> <b>3.5% silicates and opaques</b>
P10	Debris	Gray/Black	Area # 5	None Detected by TEM		0.3% fiberglass	97.3% organics and carbonates 2.4% silicates and opaques
P11	Debris	Gray/Black	Area # 6	None Detected by TEM		None Detected	61.1% organics and carbonates 38.9% silicates and opaques
P12	Debris	Gray/Black	Area # 6	None Detected by TEM		None Detected	64.7% organics and carbonates 35.3% silicates and opaques

**Key:**  
 ACM: Asbestos Containing Materials contain more than 1% asbestos (shown in bold type).  
 This method (ELAP 198.6) does not remove vermiculite and may underestimate the level of asbestos present in a sample containing greater than 10% vermiculite.  
 Trace - Asbestos found is 1% or less; not considered ACM.  
 None Detected - No asbestos found in samples using polarized light microscopy (PLM).  
 None Detected by TEM - No asbestos found in samples using transmission electron microscopy (TEM) and polarized light microscopy (PLM) was found to be negative.  
 Negative by Weight - After matrix reduction, the remainder is less than 1% and, therefore, cannot fulfill the definition of asbestos containing material.  
 Inconclusive - No asbestos found in non-friable organically bound samples using polarized light microscopy (PLM).  
 Method: EPA 600/M4-82/20, ELAP Item 198.6 This report may not be reproduced without the express permission of Enviroscience. This report cannot be used to claim endorsement of products by NVLAP or any agency of the U.S. Government. Test results only reflect conditions at the time the samples were taken.

*Edward H. Steinhilber*

Analyzed by: \_\_\_\_\_ Date Analyzed: 7/30/2014

# ENVIROSCIENCE CONSULTANTS, INC.

2150 SMITHTOWN AVE. + RONKONKOMA, NY 11779 + (631) 580-3191  
 344 MAIN ST., SUITE 101 + MT. KISCO, NY 10549 + (914) 666-8933

ELAP # 11681; NVLAP Lab Code 200531-0

## ASBESTOS BULK SAMPLE RESULTS

CLIENT: Mastics-Moriches-Shirley Community Library      SAMPLE DATE: 7/24/2014  
 PROJECT NAME: Mastic Moriches Shirley Community Library      DATE RECEIVED: 7/24/2014  
 AREA: Interior-Above Ceiling  
 JOB #: 11350      SAMPLER: Edik Ivans  
 PAGE #: 3 of 3      CUSTODY #: 11471

Sample #	Description	Color	Location	Result	% Asbestos-type	% Non-asbestos Fibers-type	% Matrix-type
P13	Debris	Gray/Black	Area # 7	27.7% Asbestos	27.7% Chrysotile	None Detected	44.6% organics and carbonates 27.7% silicates and opaques
P14	Debris	Gray/Black	Area # 7	28.3% Asbestos	28.3% Chrysotile	None Detected	35.7% organics and carbonates 36.0% silicates and opaques

**Key:**  
 ACM: Asbestos Containing Materials contain more than 1% asbestos (shown in bold type).  
 This method (ELAP 198.6) does not remove vermiculite and may underestimate the level of asbestos present in a sample containing greater than 10% vermiculite.  
 Trace - Asbestos found is 1% or less; not considered ACM.  
 None Detected - No asbestos found in samples using polarized light microscopy (PLM).  
 None Detected by TEM - No asbestos found in samples using transmission electron microscopy (TEM) and polarized light microscopy (PLM) was found to be negative.  
 Negative by Weight - After matrix reduction, the remainder is less than 1% and, therefore, cannot fulfill the definition of asbestos containing material.  
 Inconclusive - No asbestos found in non-friable organically bound samples using polarized light microscopy (PLM).  
 Method: EPA 600/M4-82/20, ELAP Item 198.6 This report may not be reproduced without the express permission of Enviroscience. This report cannot be used to claim endorsement of products by NVLAP or any agency of the U.S. Government. Test results only reflect conditions at the time the samples were taken.

*Edward J. Steinhilber*

Analyzed by: \_\_\_\_\_ Date Analyzed: 7/30/2014



# ENVIROSCIENCE CONSULTANTS, INC.

2150 SMITHTOWN AVE. + RONKONKOMA, NY 11779 + (631) 580-3191  
 344 MAIN ST., SUITE 101 + MT. KISCO, NY 10549 + (914) 666-8933

ELAP # 11681; NVLAP Lab Code 200531-0

## ASBESTOS BULK SAMPLE RESULTS

CLIENT: Mastics-Moriches-Shirley Community Library      SAMPLE DATE: 8/1/2014  
 PROJECT NAME: Mastic Moriches Shirley Community Library      DATE RECEIVED: 8/1/2014  
 AREA: Roof  
 JOB #: 11350      SAMPLER: Edik Ivans  
 PAGE #: 1 of 1      CUSTODY #: 11585

Sample #	Description	Color	Location	Result	% Asbestos-type	% Non-asbestos Fibers-type	% Matrix-type
MS1	Roof Tar	Black	South Side On Decking	None Detected by TEM	None Detected	None Detected	99.6% organics and carbonates 0.4% silicates and opaques
MS2	Roof Tar	Black	West Side On Decking	None Detected by TEM	None Detected	None Detected	99.67% organics and carbonates 0.3% silicates and opaques

**Key:**  
 ACM: Asbestos Containing Materials contain more than 1% asbestos (shown in bold type).  
 This method (ELAP 198.6) does not remove vermiculite and may underestimate the level of asbestos present in a sample containing greater than 10% vermiculite.  
 Trace - Asbestos found is 1% or less; not considered ACM.  
 None Detected - No asbestos found in samples using polarized light microscopy (PLM).  
 None Detected by TEM - No asbestos found in samples using transmission electron microscopy (TEM) and polarized light microscopy (PLM) was found to be negative.  
 Negative by Weight - After matrix reduction, the remainder is less than 1% and, therefore, cannot fulfill the definition of asbestos containing material.  
 Inconclusive - No asbestos found in non-fragile organically bound samples using polarized light microscopy (PLM).  
 Method: EPA 600/M4-82/20, ELAP Item 198.6 This report may not be reproduced without the express permission of Enviroscience. This report cannot be used to claim endorsement of products by NVLAP or any agency of the U.S. Government. Test results only reflect conditions at the time the samples were taken.

*John A. Spillitto*

Analyzed by: \_\_\_\_\_ Date Analyzed: 8/4/2014

**Appendix B - TEM Air Sample Results**



# ENVIROSCIENCE CONSULTANTS, INC.

2150 SMITHTOWN AVE. + RONKONKOMA, NY 11779 + (631) 580-3191  
 344 MAIN ST., SUITE 101 + MT. KISCO, NY 10549 + (914) 666-8933

ELAP # 11681; NVLAP Lab Code 200531-0

## TEM AIR SAMPLE RESULTS

CLIENT: Mastics-Moriches-Shirley Community Library      SAMPLE DATE: 8/3/2014  
 PROJECT NAME: Mastic Moriches Shirley Community Library      DATE RECEIVED: 8/3/2014  
 AREA: Library      SAMPLE TYPE: Ambient  
 JOB #: 11350      SAMPLER: Edik ivans  
 PAGE #: 1 of 2      CUSTODY #: 11594

Sample #	Sample Location	Start	End	Run Time Minutes	Flow Rate Average	Volume Liters	Total Asbestos Structures	Type	# of structures > 5µ	# of structures >0.5µ <5µ	Filter Conc. S/mm <sup>2</sup>	Sensitivity S/cc	Air Conc. S/cc
A1	Sub Level at Movable Storage	8:22	10:22	120	10	1200	0		0	0	0	.0043	<.0043
A2	Lower Tech Service Office	8:24	10:24	120	10	1200	0		0	0	0	.0043	<.0043
A3	Lower Level Teen Area	8:26	10:26	120	10	1200	0		0	0	0	.0043	<.0043
A4	Lower Level Meeting Room A	8:30	10:30	120	10	1200	0		0	0	0	.0043	<.0043
A5	Break Room South End Of Building	8:33	10:33	120	10	1200	0		0	0	0	.0043	<.0043
A6	Above Ceiling By Break Room	8:33	10:33	120	10	1200	0		0	0	0	.0043	<.0043
A7	Above Ceiling Adult Section East Side	8:34	10:34	120	10	1200	0		0	0	0	.0043	<.0043
A8	Above Ceiling Adult Section West Side	8:36	10:36	120	10	1200	0		0	0	0	.0043	<.0043
A9	Adult Section By Entry	8:37	10:37	120	10	1200	0		0	0	0	.0043	<.0043

S=Asbestos structures, cc=cubic centimeters, mm=millimeters, µ=micrometer  
 <=less than, >greater than, Flow Rate in liters per minute

Analyzed by: *Johanna A. Spillitto*      Date Analyzed: 8/3/2014

Samples were analyzed using Philips 400T Transmission Electron Microscope. Asbestos identification is determined by morphology, visual Selected Area Electron Diffraction (SAED), and Elemental Analysis using an Energy Dispersive X-ray Analyzer (EDAX). Concentration on the filter is calculated by taking the number of asbestos structures and dividing by the area analyzed. Air concentration is calculated by multiplying the effective filter area (EFA) by the filter concentration and then dividing by the volume of air collected in cubic centimeters (cc). The data pertaining to these calculations can be found on the Asbestos Count Sheet. The air filter concentration relates only to air fiber content. When samples are submitted by an outside agency for analysis, Enviroscience Consultants, Inc. can only guarantee the accuracy of the filter concentration. This report may not be reproduced without the express permission of Enviroscience. This report cannot be used to claim endorsement of products by NVLAP or any agency of the U.S. Government. The samples collected in the response action area demonstrated a filter concentration of asbestos less than seventy structures per square millimeter. This response action is considered complete according to EPA 40 CFR 763. A result of zero structures per square millimeter is only applicable to the area analyzed. Test results only reflect conditions at the time the samples were taken.



# ENVIROSCIENCE CONSULTANTS, INC.

2150 SMITHTOWN AVE. + RONKONKOMA, NY 11779 + (631) 580-3191  
 344 MAIN ST., SUITE 101 + MT. KISCO, NY 10549 + (914) 666-8933

ELAP # 11681; NVLAP Lab Code 200531-0

## TEM AIR SAMPLE RESULTS

CLIENT:	Mastics-Moriches-Shirley Community Library	SAMPLE DATE:	8/3/2014
PROJECT NAME:	Mastic Moriches Shirley Community Library	DATE RECEIVED:	8/3/2014
AREA:	Library	SAMPLE TYPE:	Ambient
JOB #:	11350	SAMPLER:	Edik ivans
PAGE #:	2 of 2	CUSTODY #:	11594

Sample #	Sample Location	Start	End	Run Time Minutes	Flow Rate Average	Volume Liters	Total Asbestos Structures	Type	# of structures > 5µ	# of structures >0.5µ <5µ	Filter Conc. S/mm <sup>2</sup>	Sensitivity S/cc	Air Conc. S/cc
A10	Adult Section By Security Office	8:39	10:39	120	10	1200	0		0	0	0	.0043	<.0043
A11	Adult Section East End	8:41	10:41	120	10	1200	0		0	0	0	.0043	<.0043
A12	Adult Section By Computer Index	8:43	10:43	120	10	1200	0		0	0	0	.0043	<.0043
A13	Circulation Office	8:50	10:50	120	10	1200	0		0	0	0	.0043	<.0043
A14	Children's Section West End	8:52	10:52	120	10	1200	0		0	0	0	.0043	<.0043
A15	Children's Section North End	8:54	10:54	120	10	1200	0		0	0	0	.0043	<.0043
A16	Children's Section East End	8:55	10:55	120	10	1200	0		0	0	0	.0043	<.0043
A17	Blank						0		0	0	0		
A18	Opened Field Blank						0		0	0	0		

S=Asbestos structures, cc=cubic centimeters, mm=millimeters, µ=micrometer  
 <=less than, >greater than, Flow Rate in liters per minute

Analyzed by: *John F. Spillitto* Date Analyzed: 8/3/2014

Samples were analyzed using Philips 400T Transmission Electron Microscope. Asbestos identification is determined by morphology, visual Selected Area Electron Diffraction (SAED), and Elemental Analysis using an Energy Dispersive X-ray Analyzer (EDAX). Concentration on the filter is calculated by taking the number of asbestos structures and dividing by the area analyzed. Air concentration is calculated by multiplying the effective filter area (EFA) by the filter concentration and then dividing by the volume of air collected in cubic centimeters (cc). The data pertaining to these calculations can be found on the Asbestos Count Sheet.

The air filter concentration relates only to air fiber content. When samples are submitted by an outside agency for analysis, Enviroscience Consultants, Inc. can only guarantee the accuracy of the filter concentration. This report may not be reproduced without the express permission of Enviroscience. This report cannot be used to claim endorsement of products by NVLAP or any agency of the U.S. Government.

The samples collected in the response action area demonstrated a filter concentration of asbestos less than seventy structures per square millimeter. This response action is considered complete according to EPA 40 CFR 763.

A result of zero structures per square millimeter is only applicable to the area analyzed. Test results only reflect conditions at the time the samples were taken.



**Appendix C– Lead XRF Results**

**ENVIROSCIENCE CONSULTANTS, INC.**  
 2150 SMITHTOWN AVENUE, SUITE 3  
 RONKONKOMA, NEW YORK 11779  
 PHONE: (631) 580-3191 • FACSIMILE: (631) 580-3195

**LEAD PAINT INSPECTION REPORT**

**BUILDING NAME:** MASTICS-MORICHES-SHIRLEY COMMUNITY LIBRARY **DATE:** JULY 8, 2014

**ROOM EQUIVALENT:** JOB 11350 **XRF SERIAL NUMBER:** 26952

**INSPECTOR NAME:** THOMAS KLUENDER **SIGNATURE:** *Thomas Kluender*

SAMPLE ID#	SUBSTRATE	COMPONENT	COLOR	TEST LOCATION	XRF READING	CLASSIFICATION
1051				CALIBRATION CHECK	1.1	-
1052				CALIBRATION CHECK	1.1	-
1053				CALIBRATION CHECK	1.1	-
1054	METAL	SUPPORT COLUMN	WHITE	MAIN ATRIUM	0.01	NEGATIVE
1055	METAL	SUPPORT COLUMN	WHITE	MAIN ATRIUM	0.01	NEGATIVE
1056	SHEETROCK	WALL	BLUE	MAIN AREA W1	0.00	NEGATIVE
1057	SHEETROCK	WALL	WHITE	MAIN AREA W1	0.00	NEGATIVE
1058	SHEETROCK	WALL	GREEN	MAIN AREA W3	0.00	NEGATIVE
1059	SHEETROCK	WALL	WHITE	MAIN AREA W4	0.02	NEGATIVE
1060	SHEETROCK	UPPER WALL	WHITE	MAIN AREA W3	0.00	NEGATIVE
1061	SHEETROCK	UPPER WALL	WHITE	MAIN AREA W1	0.00	NEGATIVE
1062	METAL	RAILING	WHITE	BUSINESS OFFICE STAIRCASE W1	0.00	NEGATIVE
1063	METAL	TRIM	GRAY	BUSINESS OFFICE STAIRCASE W3	0.00	NEGATIVE
1064	SHEETROCK	WALL	WHITE	BUSINESS OFFICE STAIRCASE W3	0.00	NEGATIVE



**ENVIROSCIENCE CONSULTANTS, INC.  
LEAD PAINT INSPECTION REPORT – MASTICS-MORICHES-SHIRLEY COMMUNITY LIBRARY**

SAMPLE ID#	SUBSTRATE	COMPONENT	COLOR	TEST LOCATION	XRF READING	CLASSIFICATION
1065	METAL	DOOR FRAME	WHITE	COMMUNITY SERVICE OFFICE W2	0.00	NEGATIVE
1066	WOOD	DOOR	BROWN	COMMUNITY SERVICE OFFICE	0.00	NEGATIVE
1067	METAL	DOOR FRAME	WHITE	BUSINESS OFFICE	0.00	NEGATIVE
1068	SHEETROCK	WALL	WHITE	EMPLOYEE AREA HALL W3	0.03	NEGATIVE
1069	METAL	DOOR FRAME		EMPLOYEE BATHROOM 1	0.00	NEGATIVE
1070	CERAMIC	WALL	BROWN	EMPLOYEE BATHROOM W2	0.01	NEGATIVE
1071	CERAMIC	SINK	WHITE	EMPLOYEE BATHROOM W3	7.0	POSITIVE
1072	CERAMIC	TOILET	WHITE	EMPLOYEE BATHROOM W3	0.01	NEGATIVE
1073	CERAMIC	FLOOR	TAN	EMPLOYEE BATHROOM	0.01	NEGATIVE
1074	METAL	DOOR FRAME	WHITE	BREAK ROOM 1	0.00	NEGATIVE
1075	METAL	DOOR FRAME	WHITE	LOCKER ROOM W4	0.00	NEGATIVE
1076	METAL	DOOR FRAME	WHITE	REAR EXIT W4	0.00	NEGATIVE
1077	SHEETROCK	WALL	WHITE	LOCKER ROOM W3	0.00	NEGATIVE
1078	SHEETROCK	WALL	WHITE	LOCKER ROOM W2	0.00	NEGATIVE
1079	SHEETROCK	WALL	WHITE	LOCKER ROOM W4	0.00	NEGATIVE
1080	SHEETROCK	WALL	WHITE	LOCKER ROOM W1	0.00	NEGATIVE
1081	METAL	LOCKER	BLUE	LOCKER ROOM W3	0.02	NEGATIVE
1082	METAL	DOOR FRAME	WHITE	BUSINESS RECORDS W4	0.01	NEGATIVE
1083	SHEETROCK	WALL	WHITE	BUSINESS OFFICE HALL W4	0.01	NEGATIVE
1084	SHEETROCK	WALL	WHITE	BUSINESS OFFICE HALL W2	0.00	NEGATIVE

**ENVIROSCIENCE CONSULTANTS, INC.  
LEAD PAINT INSPECTION REPORT – MASTICS-MORICHES-SHIRLEY COMMUNITY LIBRARY**

SAMPLE ID #	SUBSTRATE	COMPONENT	COLOR	TEST LOCATION	XRF READING	CLASSIFICATION
1085	SHEETROCK	WALL	WHITE	BASEMENT ALL-PURPOSE W3	0.00	NEGATIVE
1086	WOOD	STAGE TRIM	BROWN	BASEMENT ALL-PURPOSE W1	0.00	NEGATIVE
1087	METAL	DOOR FRAME	WHITE	BASEMENT ALL-PURPOSE W3	0.02	NEGATIVE
1088	METAL	RAILING	WHITE	BASEMENT ALL-PURPOSE W4	0.01	NEGATIVE
1089	SHEETROCK	WALL	TAN	MOVIE SECTION W1	0.00	NEGATIVE
1090	SHEETROCK	WALL	TAN	MOVIE SECTION W4	0.00	NEGATIVE
1091	SHEETROCK	WALL	TAN	MOVIE SECTION W3	0.00	NEGATIVE
1092	SHEETROCK	WALL	TAN	MOVIE SECTION W2	0.00	NEGATIVE
1093	METAL	SHELF	WHITE	MOVIE SECTION W3	0.00	NEGATIVE
1094	METAL	BOOK SHELF	WHITE	MAIN AREA	0.00	NEGATIVE
1095	METAL	RAILING	WHITE	YOUNG ADULT STAIRWAY	0.00	NEGATIVE
1096	PLASTER	WALL	BROWN	TEEN SERVICES W4	0.00	NEGATIVE
1097	PLASTER	WALL	BROWN	TEEN SERVICES W1	0.00	NEGATIVE
1098	PLASTER	WALL	BROWN	TEEN SERVICES W2	0.00	NEGATIVE
1099	SHEETROCK	WALL	WHITE	TEEN SERVICES W3	0.00	NEGATIVE
1100	METAL	BOOK SHELF	WHITE	TEEN SERVICES W3	0.00	NEGATIVE
1101	METAL	COLUMN	WHITE	YOUNG ADULT SECTION	0.00	NEGATIVE
1102	WOOD	DOOR FRAME	BROWN	ADULT SERVICES W2	0.00	NEGATIVE
1103	WOOD	DOOR	BROWN	ADULT SERVICES W2	0.00	NEGATIVE
1104	SHEETROCK	WALL	BLUE	ADULT SERVICES W4	0.00	NEGATIVE



**ENVIROSCIENCE CONSULTANTS, INC.  
LEAD PAINT INSPECTION REPORT – MASTICS-MORICHES-SHIRLEY COMMUNITY LIBRARY**

SAMPLE ID #	SUBSTRATE	COMPONENT	COLOR	TEST LOCATION	XRF READING	CLASSIFICATION
1105	SHEETROCK	WALL	BLUE	ADULT SERVICES W1	0.00	NEGATIVE
1106	SHEETROCK	WALL	BLUE	ADULT SERVICES W2	0.00	NEGATIVE
1107	SHEETROCK	WALL	BLUE	ADULT SERVICES W3	0.00	NEGATIVE
1108	SHEETROCK	WALL	WHITE	YOUNG ADULT W2	0.00	NEGATIVE
1109	SHEETROCK	WALL	WHITE	YOUNG ADULT W3	0.00	NEGATIVE
1110	SHEETROCK	WALL	WHITE	ADULT MYSTERY W4	0.00	NEGATIVE
1111	SHEETROCK	WALL	WHITE	YOUNG ADULT W1	0.00	NEGATIVE
1112	METAL	SHELF	WHITE	YOUNG ADULT W1	0.01	NEGATIVE
1113	METAL	SUPPORT BEAM	BLACK	YOUNG ADULT	0.00	NEGATIVE
1114	METAL	SUPPORT BEAM	BLACK	YOUNG ADULT	0.00	NEGATIVE
1115	SHEETROCK	WALL	WHITE	MEETING ROOM E W1	0.02	NEGATIVE
1116	SHEETROCK	WALL	WHITE	MEETING ROOM E W4	0.01	NEGATIVE
1117	SHEETROCK	WALL	WHITE	MEETING ROOM E W3	0.00	NEGATIVE
1118	SHEETROCK	WALL	WHITE	MEETING ROOM E W2	0.00	NEGATIVE
1119	WOOD	BOOK SHELF	BROWN	YOUNG ADULT W2	0.00	NEGATIVE
1120	WOOD	DESK	BROWN	YOUNG ADULT	0.00	NEGATIVE
1121	METAL	RAILING	WHITE	YOUNG ADULT STAIR W4	0.00	NEGATIVE
1122	STRINGER	TRIM	GRAY	YOUNG ADULT STAIR W4	0.00	NEGATIVE
1123	SHEETROCK	WALL	WHITE	CHILDREN'S SECTION W1	0.00	NEGATIVE
1124	SHEETROCK	WALL	WHITE	CHILDREN'S SECTION W1	0.01	NEGATIVE
1125	SHEETROCK	WALL	WHITE	CHILDREN'S SECTION W3	0.00	NEGATIVE

**ENVIROSCIENCE CONSULTANTS, INC.  
LEAD PAINT INSPECTION REPORT – MASTICS-MORICHES-SHIRLEY COMMUNITY LIBRARY**

SAMPLE ID #	SUBSTRATE	COMPONENT	COLOR	TEST LOCATION	XRF READING	CLASSIFICATION
1126	SHEETROCK	WALL	WHITE	CHILDREN'S SECTION W2	0.00	NEGATIVE
1127	METAL	SUPPORT COLUMN	WHITE	CHILDREN'S AREA	0.00	NEGATIVE
1128	WOOD	BOOK SHELF	BROWN	CHILDREN'S AREA	0.00	NEGATIVE
1129	METAL	BOOK SHELF	WHITE	CHILDREN'S AREA	0.00	NEGATIVE
1130	SHEETROCK	CEILING	WHITE	CHILDREN'S AREA	0.00	NEGATIVE
1131	METAL	RAILING	WHITE	CHILDREN'S AREA	0.00	NEGATIVE
1132	SHEETROCK	WALL	YELLOW	CHILDREN'S AREA W1	0.00	NEGATIVE
1133	SHEETROCK	WALL	TAN	CHILDREN'S STAFF OFFICE W3	0.00	NEGATIVE
1134	SHEETROCK	WALL	WHITE	CHILDREN'S STAFF OFFICE W1	0.00	NEGATIVE
1135	SHEETROCK	WALL	WHITE	CHILDREN'S STAFF OFFICE W2	0.00	NEGATIVE
1136	SHEETROCK	WALL	TAN	CHILDREN'S STAFF OFFICE W4	0.00	NEGATIVE
1137	CERAMIC	WALL TILE	WHITE	UPSTAIRS BATHROOM W3	0.01	NEGATIVE
1138	CERAMIC	SINK	WHITE	UPSTAIRS BATHROOM W3	-0.47	NEGATIVE
1139	CERAMIC	TOILET	WHITE	UPSTAIRS BATHROOM W4	0.08	NEGATIVE
1140	CERAMIC	FLOOR TILE	BLUE	UPSTAIRS BATHROOM	0.01	NEGATIVE
1141	WOOD	DOOR FRAME	BROWN	UPSTAIRS BATHROOM W1	0.00	NEGATIVE
1142	WOOD	DOOR	BROWN	UPSTAIRS BATHROOM W4	0.00	NEGATIVE
1143	METAL	STRUCTURAL BEAM	BLACK	CHILDREN'S AREA	0.00	NEGATIVE
1144	METAL	HVAC DUCT	BLACK	CHILDREN'S AREA	0.00	NEGATIVE
1145	METAL	SUPPORT BEAM	BLACK	CHILDREN'S AREA	0.00	NEGATIVE
1146	METAL	ROOF DECK	BLACK	CHILDREN'S AREA	0.00	NEGATIVE



**ENVIROSCIENCE CONSULTANTS, INC.  
LEAD PAINT INSPECTION REPORT – MASTICS-MORICHES-SHIRLEY COMMUNITY LIBRARY**

SAMPLE ID#	SUBSTRATE	COMPONENT	COLOR	TEST LOCATION	XRF READING	CLASSIFICATION
1147	METAL	LENTIL	ORANGE	EXTERIOR FRONT ROOF	0.00	NEGATIVE
1148	METAL	LENTIL	ORANGE	EXTERIOR FRONT ROOF	0.00	NEGATIVE
1149	METAL	LENTIL	ORANGE	EXTERIOR FRONT ROOF	0.00	NEGATIVE
1150	METAL	DOOR FRAME	WHITE	HANDICAP MEN'S BATHROOM W2	0.00	NEGATIVE
1151	WOOD	DOOR	BROWN	HANDICAP MEN'S BATHROOM W2	0.00	NEGATIVE
1152	CERAMIC	WALL TILE	WHITE	HANDICAP MEN'S BATHROOM W1	0.01	NEGATIVE
1153	METAL	STALL	BLUE	MEN'S HANDICAP BATHROOM	0.00	NEGATIVE
1154	CERAMIC	SINK	WHITE	MEN'S HANDICAP BATHROOM W2	0.06	NEGATIVE
1155	CERAMIC	TOILET	WHITE	MEN'S HANDICAP BATHROOM W4	0.03	NEGATIVE
1156	CERAMIC	FLOOR	GRAY	MEN'S HANDICAP BATHROOM	0.01	NEGATIVE
1157	METAL	DOOR FRAME	WHITE	WOMEN'S HANDICAP BATHROOM W2	0.01	NEGATIVE
1158	WOOD	DOOR	BROWN	WOMEN'S HANDICAP BATHROOM W2	0.01	NEGATIVE
1159	CERAMIC	WALL	BLUE	WOMEN'S HANDICAP BATHROOM W4	0.01	NEGATIVE
1160	METAL	STALL	BLUE	WOMEN'S HANDICAP BATHROOM W1	0.01	NEGATIVE
1161	CERAMIC	TOILET	WHITE	WOMEN'S HANDICAP BATHROOM W1	0.01	NEGATIVE
1162	CERAMIC	SINK	WHITE	WOMEN'S HANDICAP BATHROOM W2	0.01	NEGATIVE
1163	CERAMIC	FLOOR	GRAY	WOMEN'S HANDICAP BATHROOM	0.01	NEGATIVE
1164				CALIBRATION CHECK	0.9	-
1165				CALIBRATION CHECK	1.1	-
1166				CALIBRATION CHECK	1.0	-

**Appendix D – Sample Location Drawings**



ACM BULK SAMPLE LOCATIONS

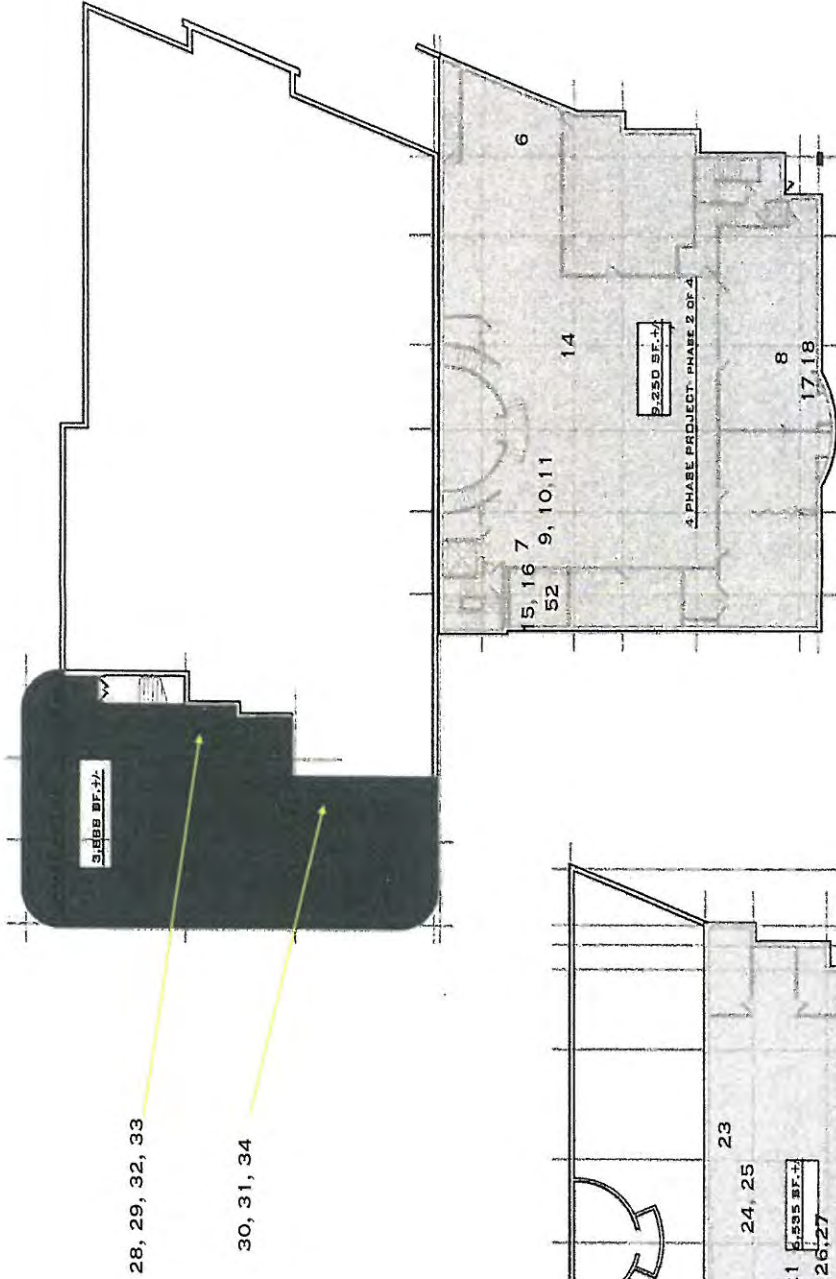

BASEMENT PLAN

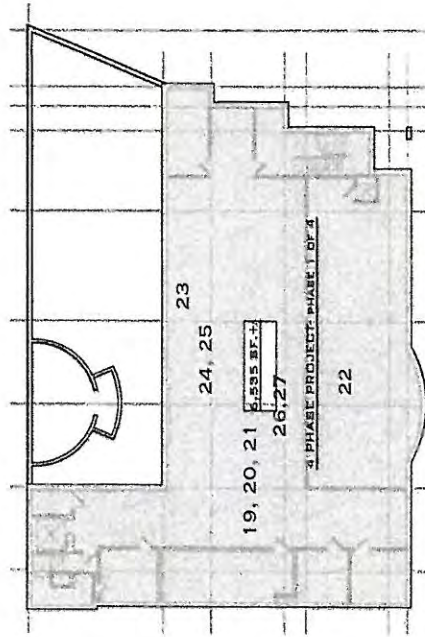

CELLAR PLAN

FOUR (4) PHASE OPTION

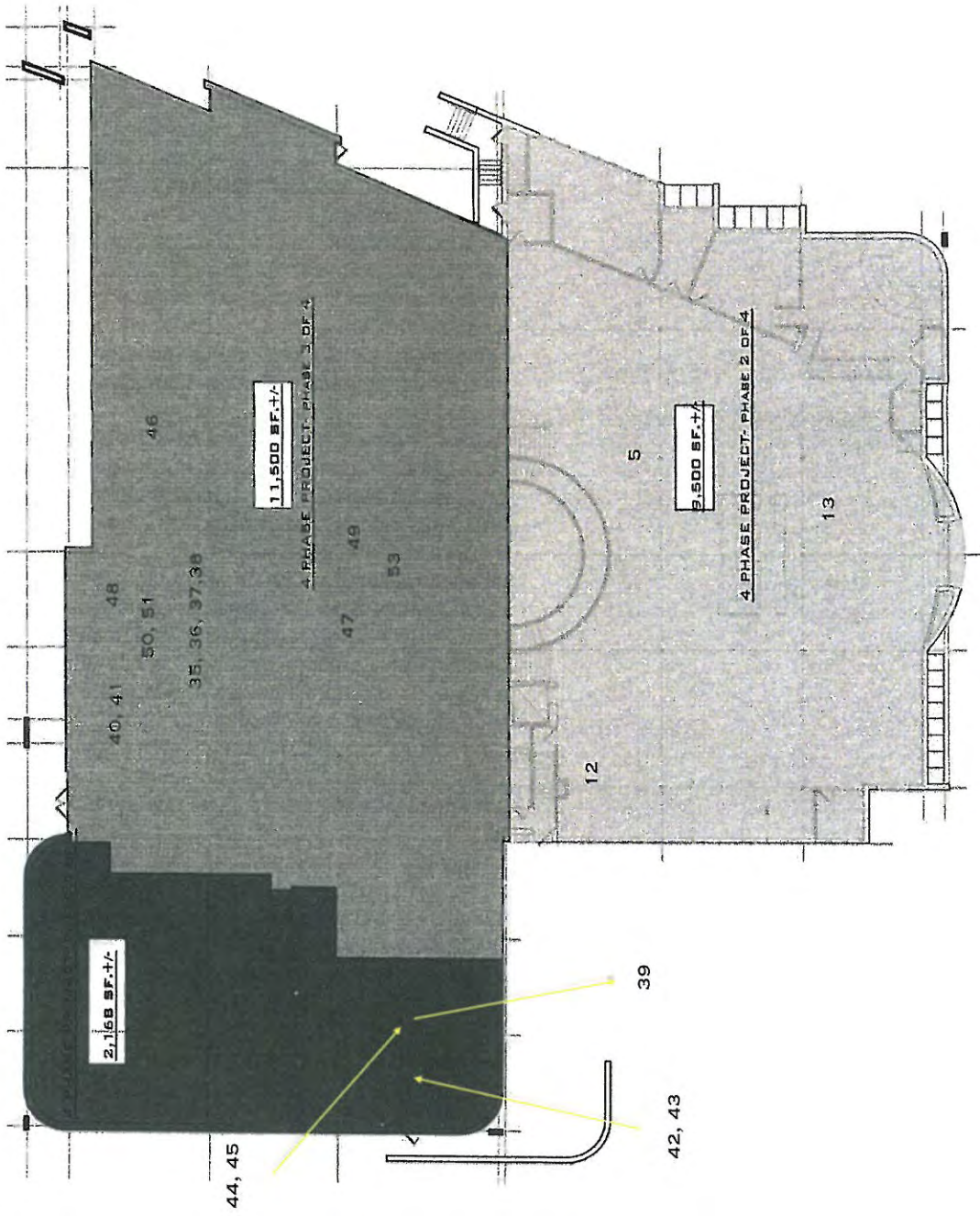

FIRST FLOOR PLAN



Samples 1-7 were taken on 7/24/14  
as indicated as "Area " on report.

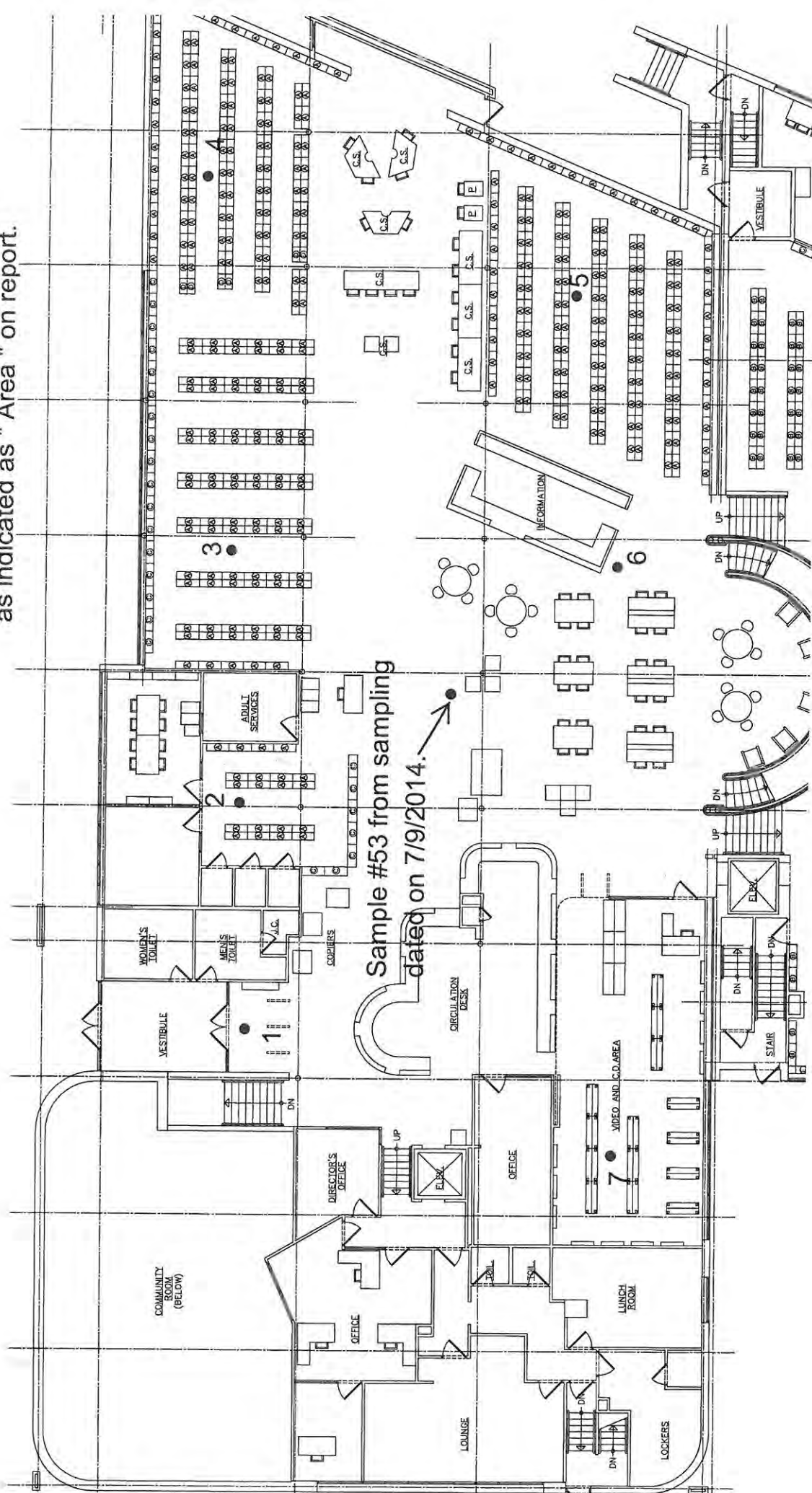

LOCATION OF TEM AIR SAMPLES - AUGUST 3, 2014

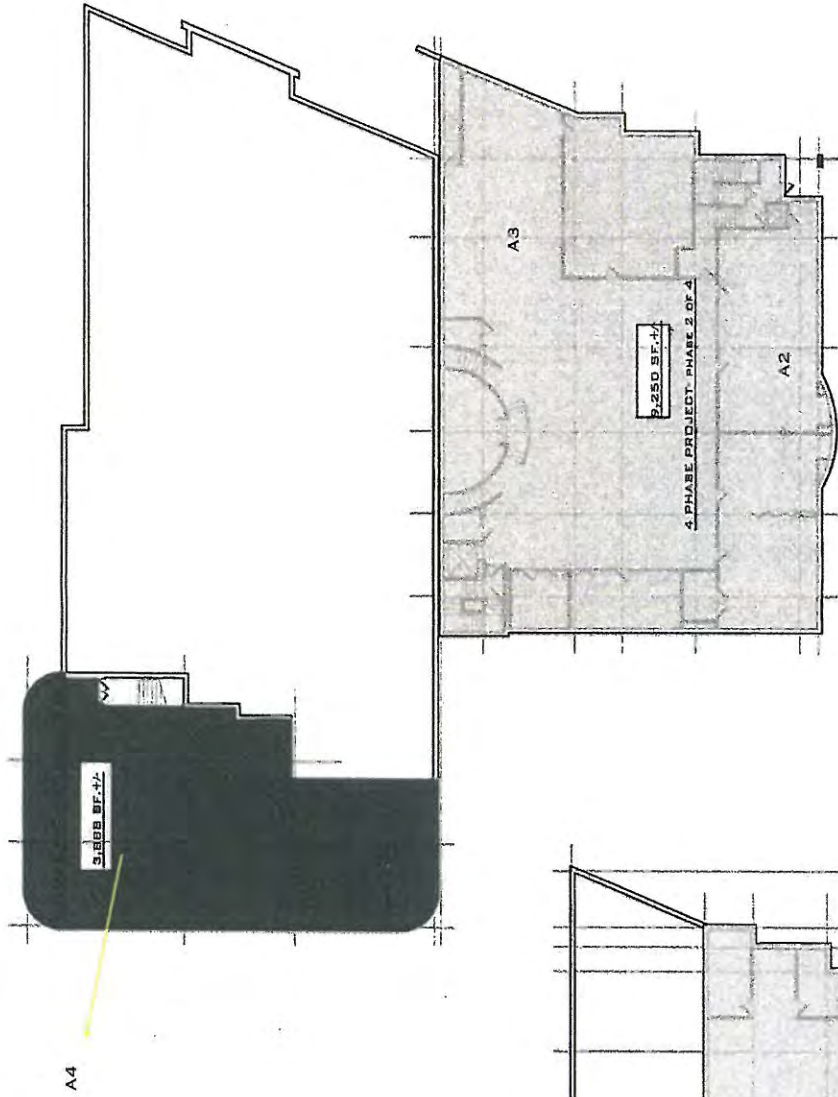

CELLAR PLAN

FOUR (4) PHASE OPTION

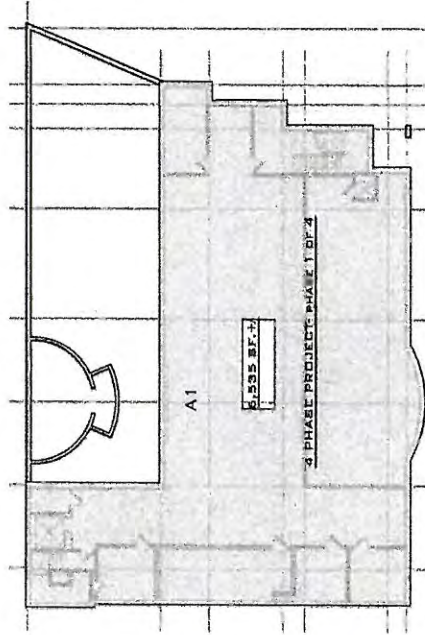



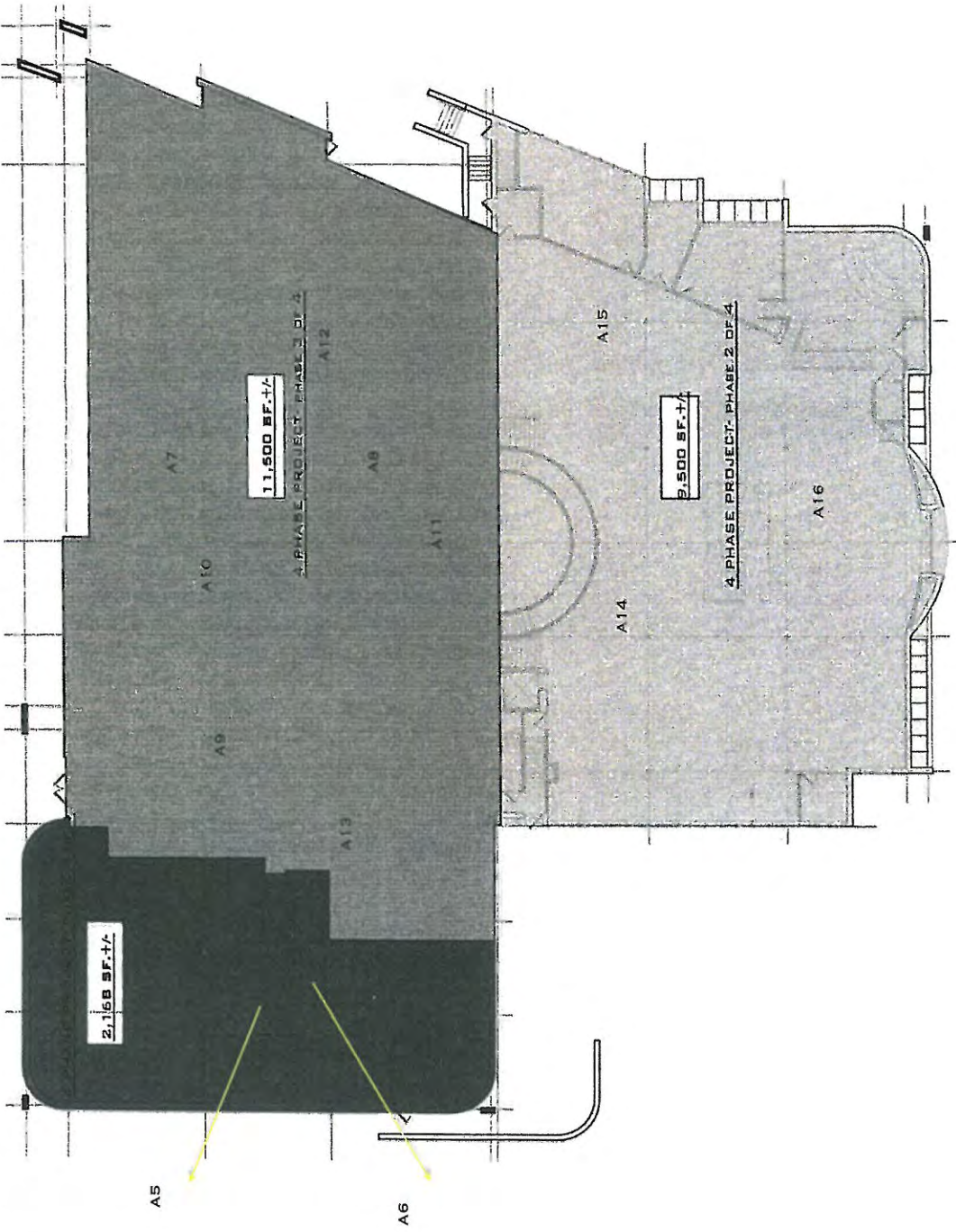

FIRST FLOOR PLAN

**Appendix E - Inventory of Asbestos Containing Materials**



**INVENTORY OF ASBESTOS CONTAINING MATERIALS  
MASTIC MORICHES SHIRLEY COMMUNITY LIBRARY**

MATERIAL	LOCATION	AMOUNT
Debris	Main Library Above Ceiling Tiles & Sheetrock	12,000 square feet

**Appendix F - Certifications**



**New York State – Department of Labor**

Division of Safety and Health  
License and Certificate Unit  
State Campus, Building 12  
Albany, NY 12240

**ASBESTOS HANDLING LICENSE**

Enviroscience Consultants, Inc.

2150 Smithtown Avenue

Ronkonkoma, NY 11779

FILE NUMBER: 99-0882

LICENSE NUMBER: 28733

LICENSE CLASS: RESTRICTED

DATE OF ISSUE: 11/15/2013

EXPIRATION DATE: 11/30/2014

Duly Authorized Representative – Thomas Kluender

This license has been issued in accordance with applicable provisions of Article 30 of the Labor Law of New York State and of the New York State Codes, Rules and Regulations (12 NYCRR Part 56). It is subject to suspension or revocation for a (1) serious violation of state, federal or local laws with regard to the conduct of an asbestos project, or (2) demonstrated lack of responsibility in the conduct of any job involving asbestos or asbestos material.

This license is valid only for the contractor named above and this license or a photocopy must be prominently displayed at the asbestos project worksite. This license verifies that all persons employed by the licensee on an asbestos project in New York State have been issued an Asbestos Certificate, appropriate for the type of work they perform, by the New York State Department of Labor.

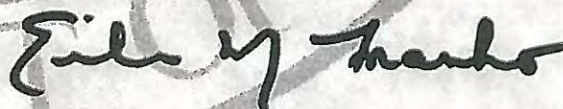

Eileen M. Franko, Acting Director  
For the Commissioner of Labor





**National Voluntary  
Laboratory Accreditation Program**



**SCOPE OF ACCREDITATION TO ISO/IEC 17025:2005**

**Enviroscience Consultants, Inc.**

2150 Smithtown Ave.

Ronkonkoma, NY 11779

Mr. Edward Detweiler

Phone: 631-580-3191 Fax: 631-580-3195

E-Mail: edetweiler@envirohealth.org

URL: <http://www.envirohealth.org>

**BULK ASBESTOS FIBER ANALYSIS (PLM)**

**NVLAP LAB CODE 200531-0**

***NVLAP Code    Designation / Description***

- 18/A01        EPA 600/M4-82-020: Interim Method for the Determination of Asbestos in Bulk Insulation Samples
- 18/A03        EPA 600/R-93/116: Method for the Determination of Asbestos in Bulk Building Materials

2013-10-01 through 2014-09-30

*Effective dates*

*For the National Institute of Standards and Technology*



United States Department of Commerce  
National Institute of Standards and Technology

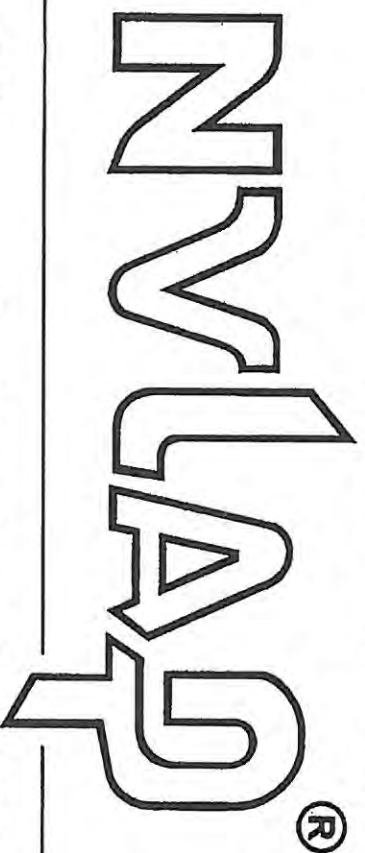

## Certificate of Accreditation to ISO/IEC 17025:2005

NVLAP LAB CODE: 200531-0

**Enviroscience Consultants, Inc.**  
Ronkonkoma, NY

*is accredited by the National Voluntary Laboratory Accreditation Program for specific services,  
listed on the Scope of Accreditation, for:*

### **BULK ASBESTOS FIBER ANALYSIS**

*This laboratory is accredited in accordance with the recognized International Standard ISO/IEC 17025:2005.  
This accreditation demonstrates technical competence for a defined scope and the operation of a laboratory quality  
management system (refer to Joint ISO-ILAC-IAF Communiqué dated January 2009).*

2013-10-01 through 2014-09-30

*Effective dates*



A handwritten signature in black ink, appearing to read "D. Wild".

*For the National Institute of Standards and Technology*



**SCOPE OF ACCREDITATION TO ISO/IEC 17025:2005**

**Enviroscience Consultants, Inc.**  
2150 Smithtown Ave.  
Ronkonkoma, NY 11779  
Mr. Edward Detweiler  
Phone: 631-580-3191 Fax: 631-580-3195  
E-Mail: edetweiler@envirohealth.org  
URL: <http://www.envirohealth.org>

**AIRBORNE ASBESTOS FIBER ANALYSIS (TEM)**

**NVLAP LAB CODE 200531-0**

***NVLAP Code Designation / Description***

18/A02 U.S. EPA's "Interim Transmission Electron Microscopy Analytical Methods-Mandatory and Nonmandatory-and Mandatory Section to Determine Completion of Response Actions" as found in 40 CFR, Part 763, Subpart E, Appendix A.

2013-10-01 through 2014-09-30

*Effective dates*

A handwritten signature in black ink, appearing to read "William R. M. L.", written over a horizontal line.

*For the National Institute of Standards and Technology*

United States Department of Commerce  
National Institute of Standards and Technology

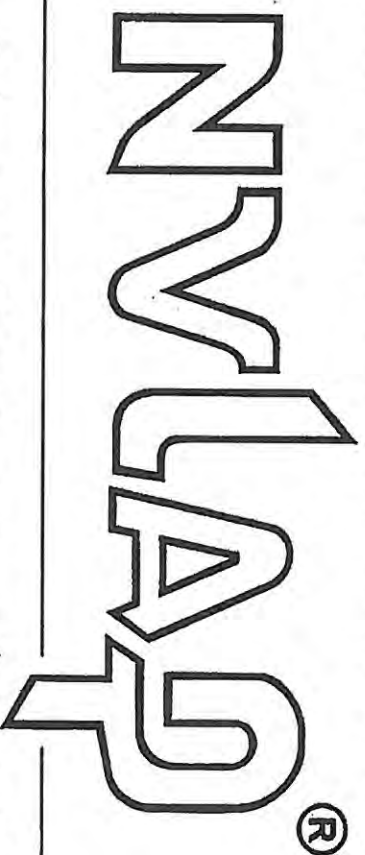

---

**Certificate of Accreditation to ISO/IEC 17025:2005**

---

NVLAP LAB CODE: 200531-0

**Enviroscience Consultants, Inc.**  
Ronkonkoma, NY

*is accredited by the National Voluntary Laboratory Accreditation Program for specific services,  
listed on the Scope of Accreditation, for:*

**AIRBORNE ASBESTOS FIBER ANALYSIS**

*This laboratory is accredited in accordance with the recognized International Standard ISO/IEC 17025:2005.  
This accreditation demonstrates technical competence for a defined scope and the operation of a laboratory quality  
management system (refer to joint ISO-ILAC-IAF Communiqué dated January 2009).*

2013-10-01 through 2014-09-30

*Effective dates*



*For the National Institute of Standards and Technology*

A handwritten signature in black ink, appearing to read "D. Wild".



NEW YORK STATE DEPARTMENT OF HEALTH  
WADSWORTH CENTER



Expires 12:01 AM April 01, 2015  
Issued April 01, 2014

**CERTIFICATE OF APPROVAL FOR LABORATORY SERVICE**

*Issued in accordance with and pursuant to section 502 Public Health Law of New York State*

**MR. GLENN L. NEUSCHWENDER**  
**ENVIROSCIENCE CONSULTANTS, INC.**  
**2150 SMITHTOWN AVENUE SUITE 3**  
**RONKONKOMA, NY 11779**

**NY Lab Id No: 11681**

*is hereby APPROVED as an Environmental Laboratory for the category*  
**ENVIRONMENTAL ANALYSES SOLID AND HAZARDOUS WASTE**  
*All approved subcategories and/or analytes are listed below:*

**Miscellaneous**

Asbestos in Friable Material	Item 198.1 of Manual EPA 600/M4/82/020
Asbestos in Non-Friable Material-PLM	Item 198.6 of Manual (NOB by PLM)
Asbestos in Non-Friable Material-TEM	Item 198.4 of Manual

**Serial No.: 50764**

Property of the New York State Department of Health. Certificates are valid only at the address shown; must be conspicuously posted, and are printed on secure paper. Continued accreditation depends on successful ongoing participation in the Program. Consumers are urged to call (518) 485-5570 to verify the laboratory's accreditation status.

NEW YORK STATE DEPARTMENT OF HEALTH  
WADSWORTH CENTER



Expires 12:01 AM April 01, 2015  
Issued April 01, 2014

**CERTIFICATE OF APPROVAL FOR LABORATORY SERVICE**

*Issued in accordance with and pursuant to section 502 Public Health Law of New York State*

**MR. GLENN L. NEUSCHWENDER**  
**ENVIROSCIENCE CONSULTANTS, INC.**  
**2150 SMITHTOWN AVENUE SUITE 3**  
**RONKONKOMA, NY 11779**

**NY Lab Id No: 11681**

*is hereby APPROVED as an Environmental Laboratory for the category*  
**ENVIRONMENTAL ANALYSES AIR AND EMISSIONS**  
*All approved subcategories and/or analytes are listed below:*

**Miscellaneous Air**

**Asbestos**

**40 CFR 763 APX A No. III**

**YAMATE, AGARWAL GIBB**

**Fibers**

**NIOSH 7400 A RULES**

**Serial No.: 50765**



Property of the New York State Department of Health. Certificates are valid only at the address shown, must be conspicuously posted, and are printed on secure paper. Continued accreditation depends on successful ongoing participation in the Program. Consumers are urged to call (516) 485-5570 to verify the laboratory's accreditation status.

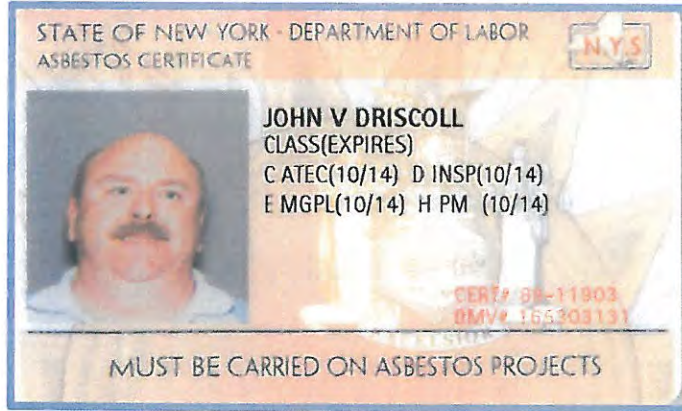





STATE OF NEW YORK - DEPARTMENT OF LABOR  
ASBESTOS CERTIFICATE



**EDIK IVANS**  
CLASS(EXPIRES)  
C ATEC(01/15) D INSP(01/15)  
H PM (01/15)

CERT# 01-15769  
DMV# 265375308

MUST BE CARRIED ON ASBESTOS PROJECTS

# United States Environmental Protection Agency

This is to certify that

Enviroscience Consultants, Inc.

has fulfilled the requirements of the Toxic Substances Control Act (TSCA) Section 402, and has received certification to conduct lead-based paint activities pursuant to 40 CFR Part 745.226

In the Jurisdiction of:

New York

This certification is valid from the date of issuance and expires

May 28, 2016

NY-1327-5

Certification #

March 28, 2013

Issued On



*Michelle Price*

Michelle Price, Chief

Lead, Heavy Metals, and Inorganics Branch



**New York  
INSPECTOR**

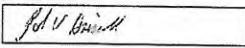

**Certified Lead-Based  
Paint Professional**

Certification No. NY-I-1043-4	
Date of Birth 10/08/1964	Expiration Date 11/15/2015
Address  12 Noahs Path Rocky Point, NY 11778	
Badge Holder's Name  John Vincent Driscoll	
Badge Holder's Signature  	



If found, drop in any mailbox  
Postmaster: Please return to:

US EPA